

Instructions for Language Settings

Note: When using FuSioN it is important that your PC language settings are set as English (Australia) and not English USA.

The following will outline how to change the settings in the following browsers (click on the title to navigate to the relevant section):

CHANGING SETTINGS IN INTERNET EXPLORER:	2
CHANGING SETTINGS IN GOOGLE CHROME:	4
CHANGING SETTINGS IN MICROSOFT EDGE:	6

CHANGING SETTINGS IN INTERNET EXPLORER:

1. Click on the **Tools** menu title.
2. Click on **Internet Options**.

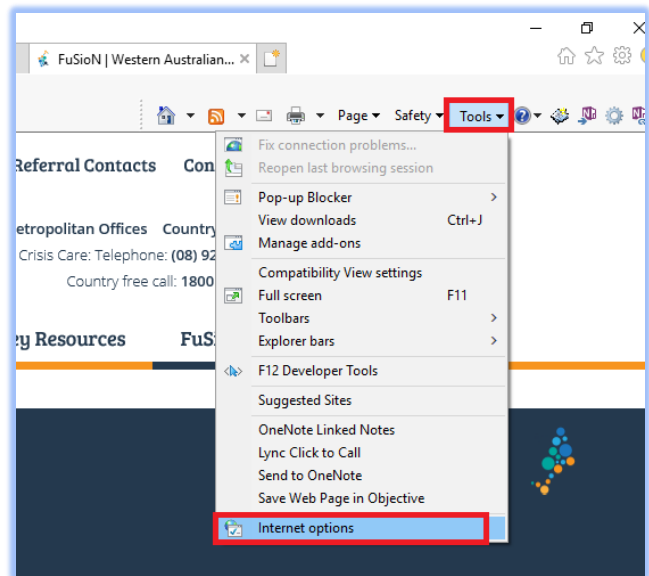

3. Click on **Languages**

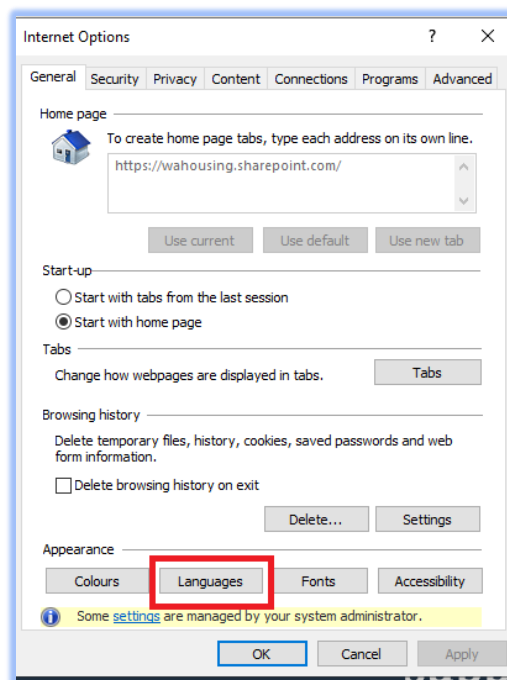

4. Select **Set Language Preferences**

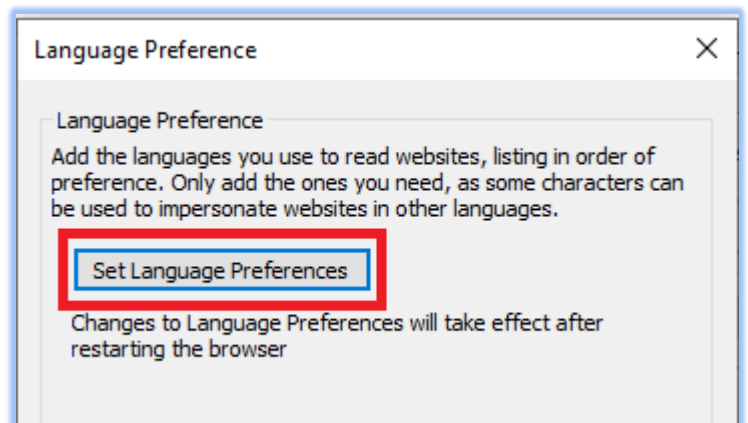

5. Windows display language should be set as **English (Australia)**, if not click **Add a Language**

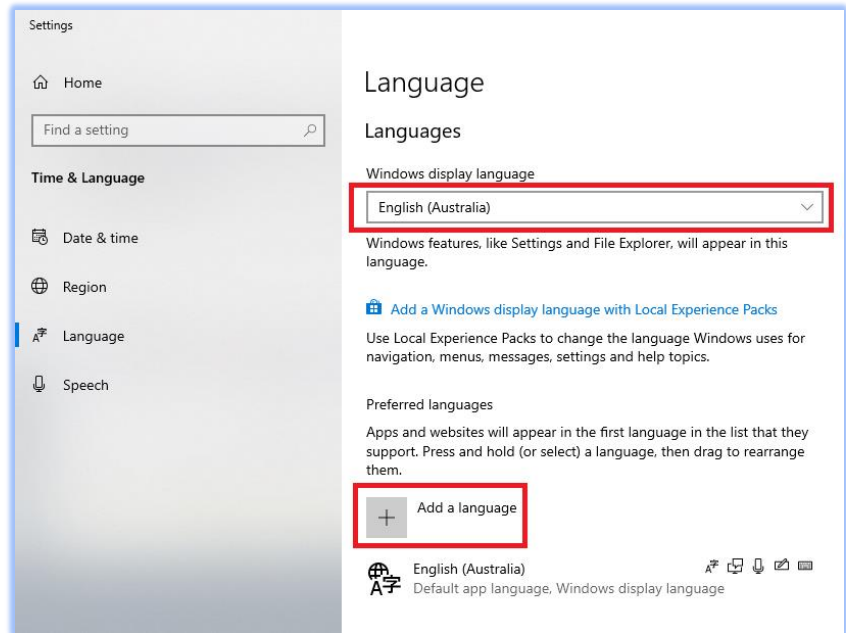

6. To change the settings, search for and select **English (Australia)**. Click **Next**

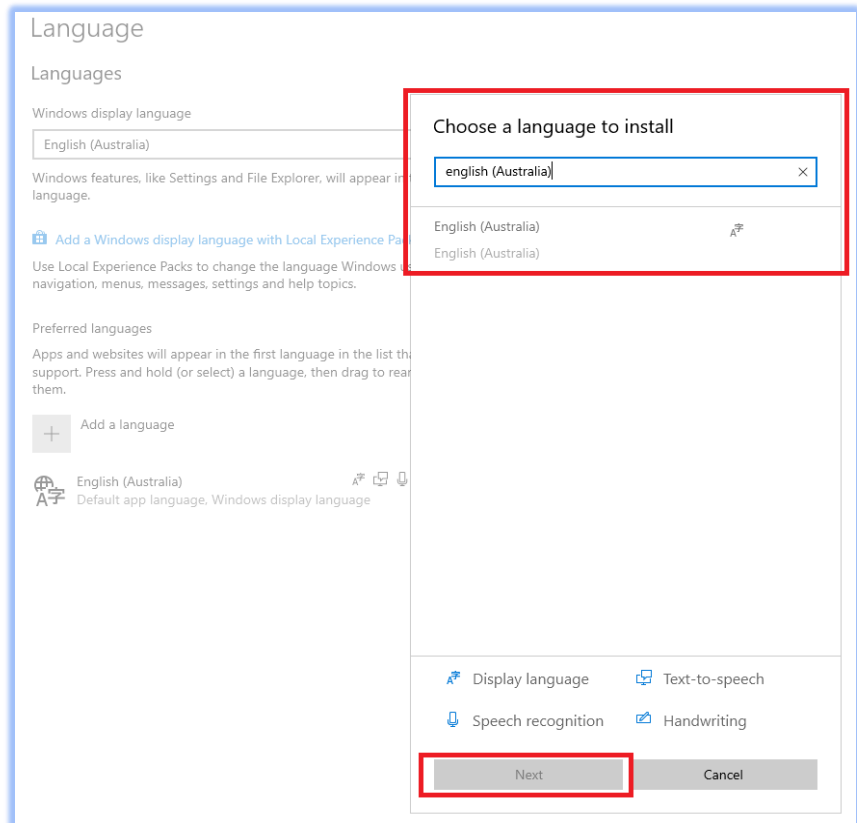

7. Click on **Install**

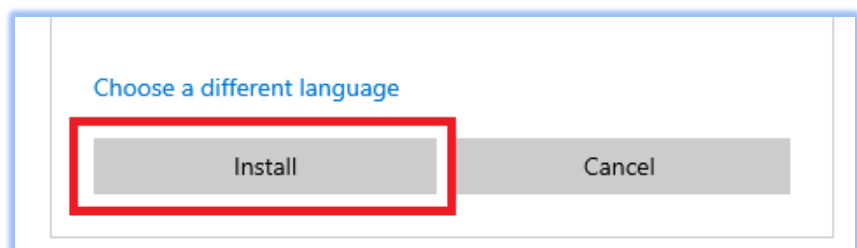

CHANGING SETTINGS IN GOOGLE CHROME:

1. Navigate to the Settings by clicking on the  icon

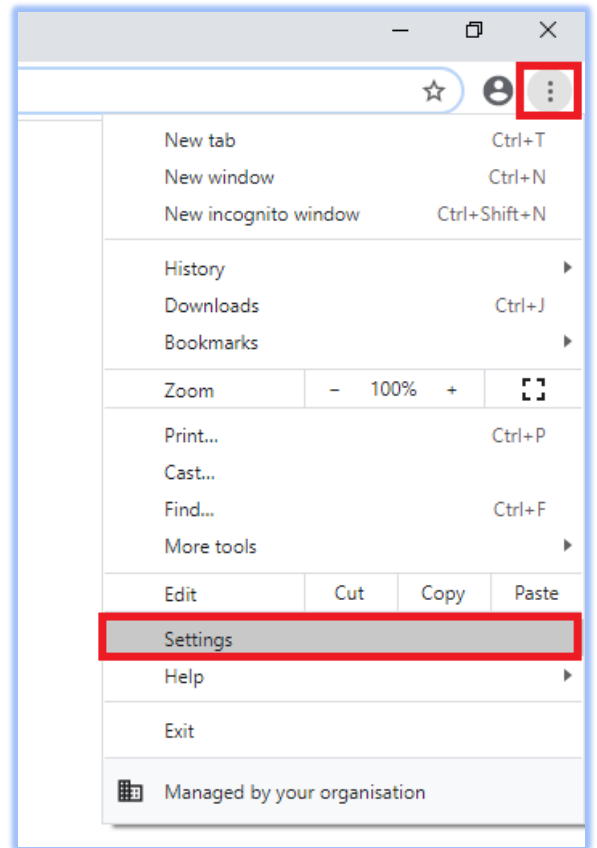

2. Click on the arrow next to **Advanced** and select **Languages**

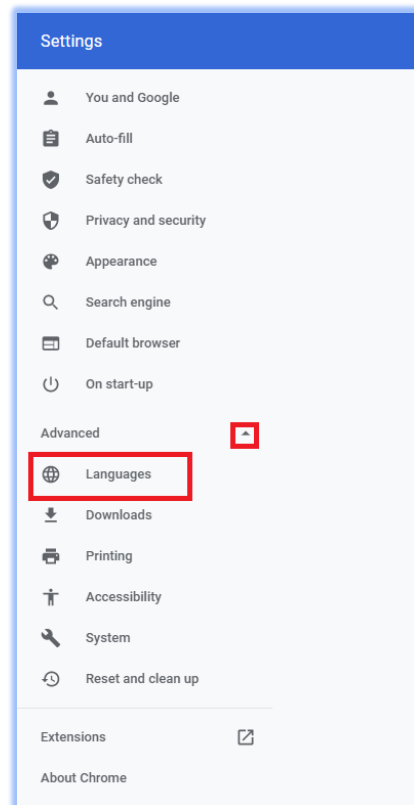

3. In the **Language** section, ensure **English (Australia)** is at the top of the list.

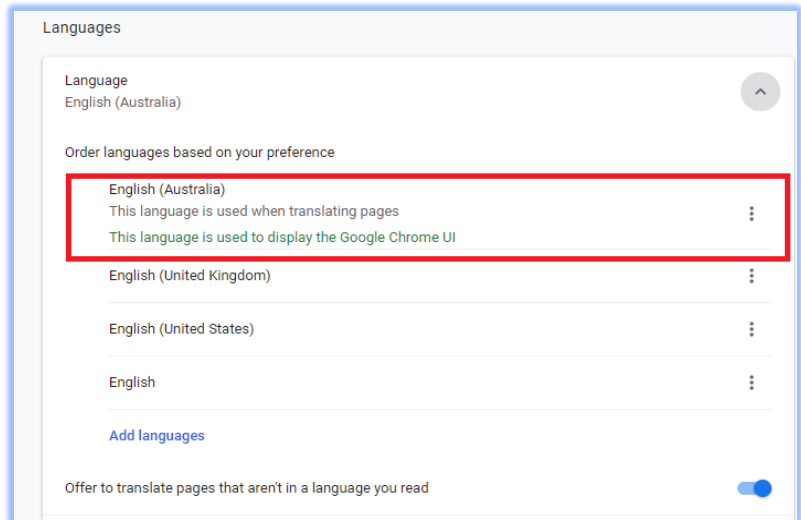

4. If it is not at the top of the list (but is displaying in the list) click on the **⋮ icon** next to it and then select:

Display Google Chrome in this language which will move it to the top of the list.

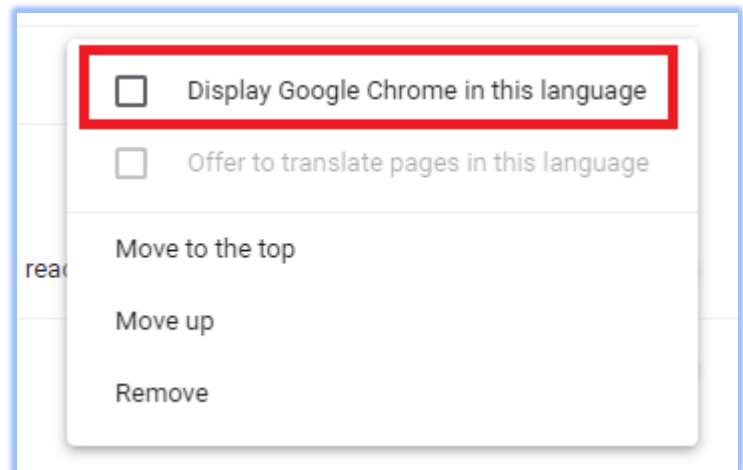

5. If it is not in the list at all, click on **Add Languages** and search for **English (Australia)** and click on **Add**.

Then click on the **⋮ icon** next to it and then select:

Display Google Chrome in this language

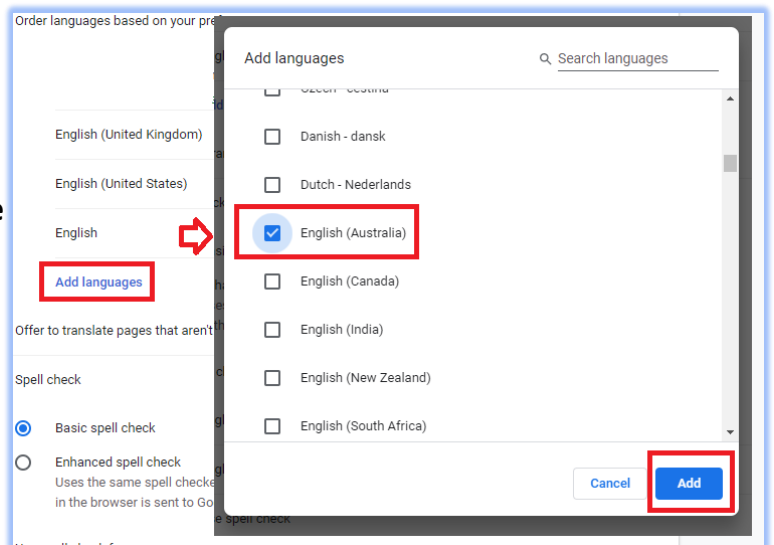

CHANGING SETTINGS IN MICROSOFT EDGE:

1. Navigate to the **Settings** by clicking on this  icon

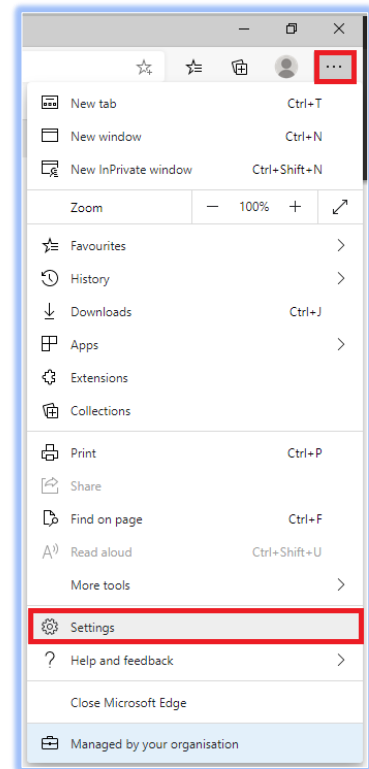

2. Select **Languages**

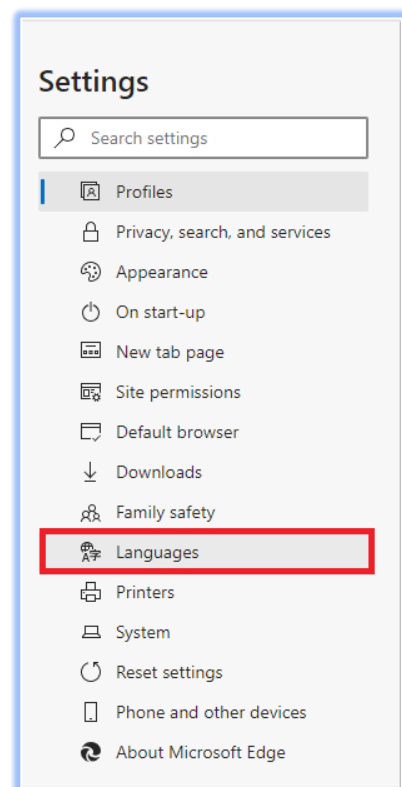

3. To add a **language** to the list of Preferred languages, select **Add languages**

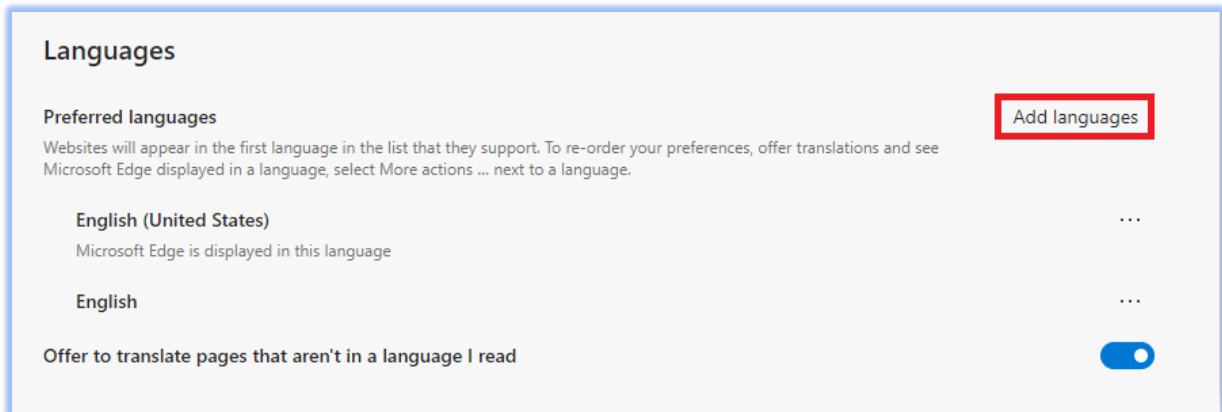

4. Search for **English (Australia)** and click on **Add**

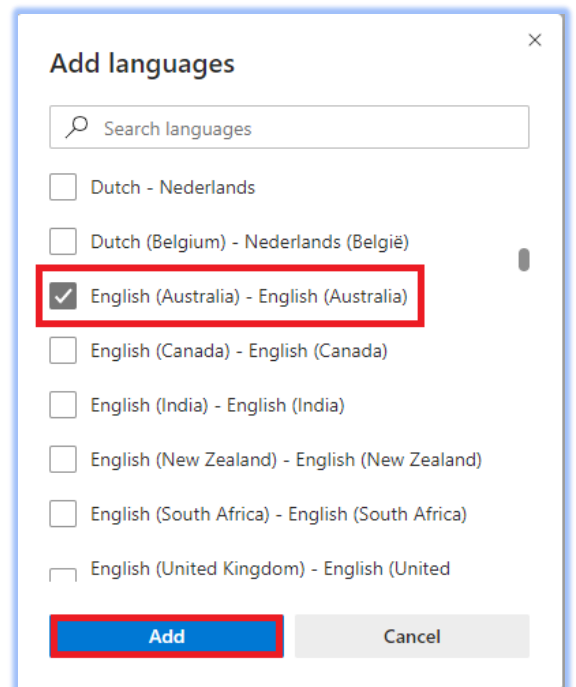

5. Once the **language** is added, select **...** next to the **language**, and then choose **Display Microsoft Edge in this language**.

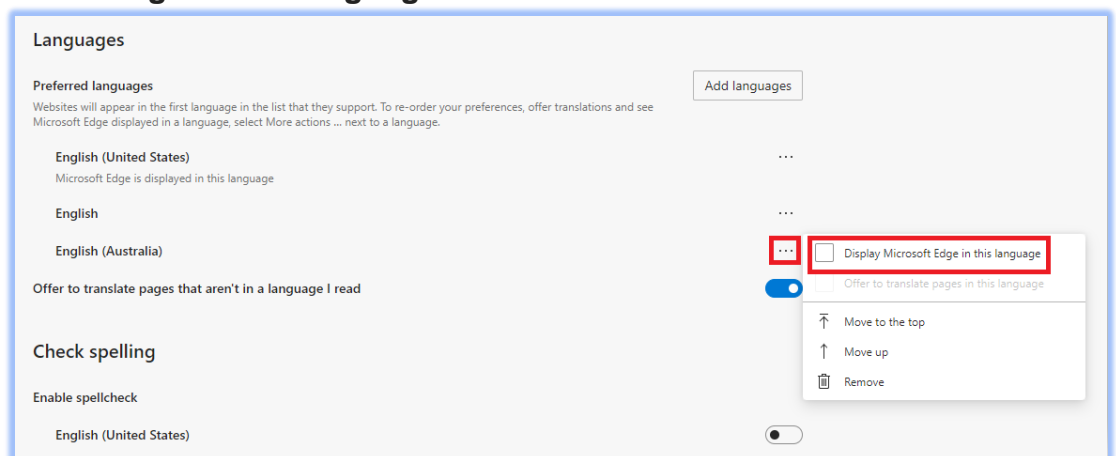

6. You will need to restart your browser for the language settings to take effect:

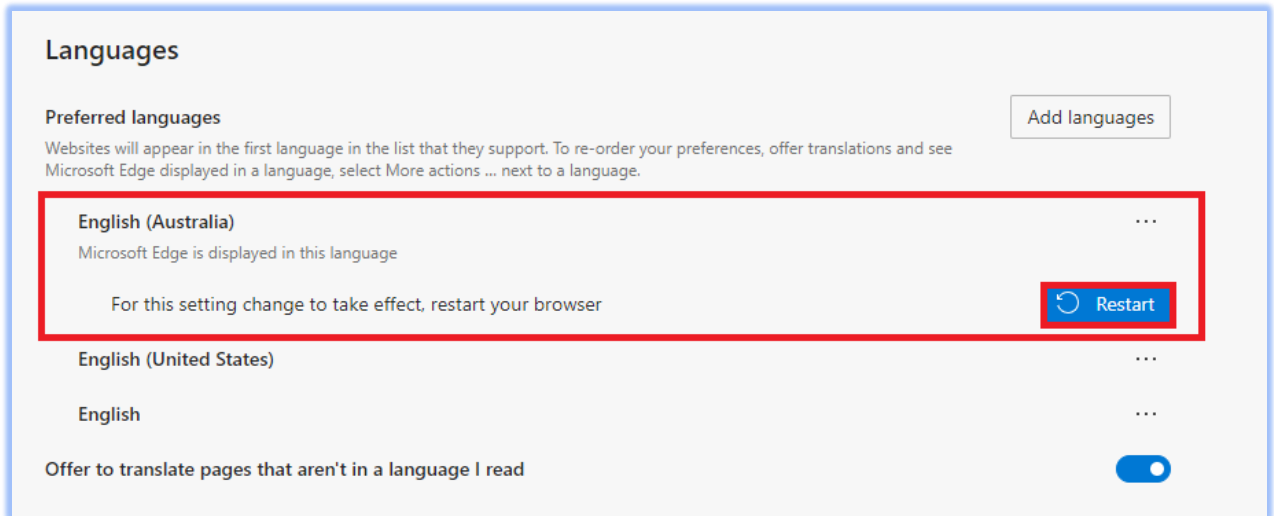

Languages

Preferred languages Add languages

Websites will appear in the first language in the list that they support. To re-order your preferences, offer translations and see Microsoft Edge displayed in a language, select More actions ... next to a language.

English (Australia) Microsoft Edge is displayed in this language	...
For this setting change to take effect, restart your browser	Restart
English (United States)	...
English	...

Offer to translate pages that aren't in a language I read